

# Tapered Plugs

## TP02



### Specification

Material: Polyethylene PE-LD

Type: Without thread, Inside

Color: Red

Minimum order quantity: 1000 pieces

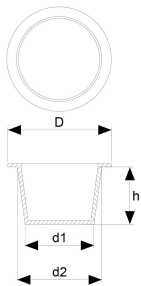

### Sizes

Article num..	Dimensions						Minimum order quantity
	d1 (mm)	d2 (mm)	h (mm)	D (mm)	Gwint zewnętrzny	Gwint wewnętrzny	
TP02-2.9	2.9	4.6	9.5	7.9	-	-	10000
TP02-4.4	4.4	6.1	9.5	9.5	M4	M6, 1/4" UNF	10000
TP02-4.7	4.7	8.5	22.5	11.7	-	-	10000
TP02-5.6	5.6	7	8.4	10.5	-	-	10000

Article num..	Dimensions						Minimum order quantity
	d1 (mm)	d2 (mm)	h (mm)	D (mm)	Gwint zewnętrzny	Gwint wewnętrzny	
TP02-6.2	6.2	7.6	9.5	11.1	M5/M6		10000
TP02-7.7	7.7	9.3	8	12.7	1/4" UNF	-	10000
TP02-7.7B	7.7	9.1	9.5	12.7	-	3/8" UNF	10000
TP02-8.4	8.4	10	9.5	13.5			10000
TP02-8.6	8.6	10.3	9.8	13.7	-	-	10000
TP02-9	9	10.7	11.5	13.9	-	-	10000
TP02-9.4	9.4	10.8	8.5	14	-	-	10000
TP02-10	10	11.8	9.5	15		M12	10000
TP02-10.6	10.6	12.2	9.8	15.6	-	-	10000
TP02-10.9	10.9	12.3	9.3	15.9	1/8" GAS	1/4" GAS, 1/2" UNF	10000
TP02-11.2	11.2	14	18.5	17.5	-	-	10000
TP02-11.3	11.3	12.9	8.5	16.3	-	-	10000

Article num..	Dimensions						Minimum order quantity
	d1 (mm)	d2 (mm)	h (mm)	D (mm)	Gwint zewnętrzny	Gwint wewnętrzny	
TP02-11.3B	11.3	13.2	11	17	-	-	10000
TP02-11.5	11.5	13	9.5	16.7	-	M14	10000
TP02-12	12	14.8	11	17.5	-	-	5000
TP02-12.1	12.1	13.9	11	17.5	M12	9/16" UNF	5000
TP02-12.5	12.5	14	8.9	17.5	7/16" UNF	-	5000
TP02-12.8	12.8	15.1	23.1	18.5	-	-	4000
TP02-13.6	13.6	15.3	11.2	19		M16, 5/8" UNF	5000
TP02-14.2	14.2	16	12.1	19	M14, 9/16" UNF	3/8" GAS	5000
TP02-14.7	14.7	17	12.7	20.6	-	M18	5000
TP02-14.9	14.9	16.4	11.5	21	-	-	5000
TP02-15.5	15.5	17.1	8.5	20.6	-	-	5000
TP02-16.1	16.1	17.6	8.5	21	-	-	5000

Article num..	Dimensions						Minimum order quantity
	d1 (mm)	d2 (mm)	h (mm)	D (mm)	Gwint zewnętrzny	Gwint wewnętrzny	
TP02-16.4	16.4	18.3	12.3	22.2			5000
TP02-16.6	16.6	18.5	13	21.9	-	-	6000
TP02-17.1	17.1	19.4	13	22	3/8" GAS	M20 x 1.5	6500
TP02-17.2	17.2	20.2	18	24.2	-	-	4000
TP02-17.5	17.5	20.1	14.5	24	M18 x 1.5, M18 x 2	1/2" GAS	5000
TP02-17.7	17.7	19.6	12.7	22.2	3/8" GAS	M20	5000
TP02-17.8	17.8	20	13.4	23.8	M18	1/2"GAS	5000
TP02-18.3	18.3	21.4	17.5	25.4	-	-	4000
TP02-18.5	18.5	20.9	14.3	24.6	3/4" UNF	M22	5000
TP02-19	19	21.5	14.3	25.8	-	M22, 7/8" UNF	4000
TP02-19.4	19.4	22.5	19	26.5	-	-	3000
TP02-20.5	20.5	23.2	17.5	27.2	-	-	3000

Article num..	Dimensions						Minimum order quantity
	d1 (mm)	d2 (mm)	h (mm)	D (mm)	Gwint zewnętrzny	Gwint wewnętrzny	
TP02-21.2	21.2	23.2	12.3	27.3	-	M24	4000
TP02-21.3	21.3	23.2	15.9	27	M20, 1/2" GAS	5/8" GAS	3000
TP02-22	22	24.8	17	29	M22 x 2	-	3000
TP02-22B	22	25	15.9	28.5	M22	1" UNF	3000
TP02-22.5	22.5	25.5	17.8	28.9	7/8" UNF	-	5000
TP02-22.7	22.7	24.9	12	27	-	-	3000
TP02-23.4	23.4	26.4	17.5	29.3	M24, 5/8" GAS	3/4" GAS M27, M26	2500
TP02-24	24	26.9	18	31	-	-	2000
TP02-24.6	24.6	29.5	27.5	34	-	-	1500
TP02-24.7	24.7	27.7	19	32	M27, 1" UNF	1.1/8" UNF	2000
TP02-25.2	25.2	29.2	19	33	-	-	1500
TP02-26.6	26.6	29.7	26.3	31.6	3/4" GAS	7/8" GAS	1500

Article num..	Dimensions						Minimum order quantity
	d1 (mm)	d2 (mm)	h (mm)	D (mm)	Gwint zewnętrzny	Gwint wewnętrzny	
TP02-28	28	30.9	19	35.3	M27, M28	M30	2000
TP02-29.2	29.2	31.2	12.7	34.7	M22 x 2	-	2000
TP02-30	30	32.6	15.2	36.7	M30	M33, 1" GAS	2000
TP02-30.5	30.5	33.3	14.5	37	7/8" GAS	-	2000
TP02-31.1	31.1	34.3	17.5	38.1	-	1.3/8" UNF	1500
TP02-31.1B	31.1	34.4	19	38.1	1.1/4" UNF	M35	1500
TP02-31.6	31.6	36.3	24.1	40.2	1.5/16" UNF	-	1000
TP02-33.3	33.3	34.4	9.5	38.1	-	-	2500
TP02-33.3B	33.3	37.2	22.2	41.6	1.1/8" GAS	1.1/2" UNF	1000
TP02-33.6	33,6	37,9	12	42.7	-	-	1000
TP02-33.9	33.9	38.3	24.5	42.3	-	-	1000
TP02-33.9B	33.9	37.3	12.3	42.2	1.3/8" UNF	1.5/8" UNF	2000

Article num..	Dimensions						Minimum order quantity
	d1 (mm)	d2 (mm)	h (mm)	D (mm)	Gwint zewnętrzny	Gwint wewnętrzny	
TP02-34.9	34.9	36.4	8.2	42.7	-	-	2500
TP02-35.9	35.9	40.2	24.5	44.1	-	-	1000
TP02-36.3	36.3	38.3	12	42.3	-	-	1500
TP02-36.9	36.9	40.6	22.5	44	1.1/8" GAS	1.1/4" GAS	1000
TP02-38.6	38.6	40.6	12.7	44.5	1.1/2" UNF	-	1500
TP02-39.6	39.6	42.7	18.5	47.6	1.3/8" GAS	M42, M45, 1.3/8" GAS	1000
TP02-40.8	40.8	44.7	24	49	-	-	500
TP02-41.4	41.4	44.8	19	49.2	1.1/4" GAS	M45	1000
TP02-42.5	42.5	44.8	12.6	50.7	-	-	1000
TP02-43.4	43.4	48.5	24.5	53.3	-	-	600
TP02-44.1	44.1	46.7	18.4	49.8	-	-	800
TP02-44.4	44.4	47.7	19	51	M45 x 1.5/2/3		1500

Article num..	Dimensions						Minimum order quantity
	d1 (mm)	d2 (mm)	h (mm)	D (mm)	Gwint zewnętrzny	Gwint wewnętrzny	
TP02-45.2	45.2	49	24.5	53.4	1.3/8"GAS	1.1/2"GAS	600
TP02-45.9	45.9	46.3	9.5	50.8	-	M48	1500
TP02-46	46	50	24.8	54	-	-	500
TP02-47.2	47.2	51.9	24	55.8	-	-	500
TP02-47.5	47.5	50.3	25	54	-	-	500
TP02-48	48	52.7	25.4	57.1	-	-	500
TP02-48.6	48.6	51.2	18.7	55.5	1.1/2" GAS	M52	500
TP02-49.8	49.8	54	24.3	58	1.1/2" GAS	M52	500
TP02-51.1	51.1	54.4	25	57	-	-	500
TP02-51.5	51.5	53,8	12	58,2	-	-	500
TP02-53.5	53.5	57	25.1	62.4	1.3/4" GAS	M56, M55	400
TP02-54	54	58.4	24.5	62.4	-	-	400



Article num..	Dimensions						Minimum order quantity
	d1 (mm)	d2 (mm)	h (mm)	D (mm)	Gwint zewnętrzny	Gwint wewnętrzny	
TP02-55	55	61	25	65	-	-	400
TP02-55.4	55.4	58.8	25.1	65	M58	M60, M58, 2" GAS	400
TP02-57.5	57.5	57.6	12.8	63.6	-	-	700
TP02-59.3	59.3	67.3	31.7	70.3	-	-	300
TP02-59.6	59.6	62.6	24.6	66.7	M60, 2" GAS	M62, M60	300
TP02-62	62	66.4	28	71	-	-	300
TP02-63.3	63.3	69.8	25.4	73	-	-	400
TP02-64.5	64.5	67.3	15.8	70.6	-	-	400
TP02-68.1	68.1	70.9	19	74.6	-	-	400
TP02-70	70	75.8	25.4	79.4	-	M76, M75, 2.1/2" GAS	300
TP02-74	74	77	18.7	82.5	-	-	300
TP02-74B	74	76.8	24.4	80	-	-	600

Article num..	Dimensions						Minimum order quantity
	d1 (mm)	d2 (mm)	h (mm)	D (mm)	Gwint zewnętrzny	Gwint wewnętrzny	
TP02-76.8	76.8	82.2	25.4	85.7	-	-	500
TP02-77.1	77.1	80.7	19	85.7	2.1/2" GAS	-	300
TP02-80	80	86.1	25.1	89.8	-	3" GAS	500
TP02-84.2	84.2	90.8	28	94.5	3" GAS	-	500
TP02-85.3	85.3	88	19	92	-	-	250
TP02-87.5	87.5	93.6	34.3	96.7	-	-	250
TP02-88.1	88.1	93.3	28.6	96.5	-	-	300
TP02-92.1	92.1	97	32	100	-	-	300
TP02-93.5	93.5	100.3	26.5	107.5	-	-	400
TP02-94.5	94.5	100.6	34.5	103.6	-	-	100
TP02-96.5	96.5	102	31	110	-	-	200
TP02-98	98	102	24.7	107.2	-	-	400

Article num..	Dimensions						Minimum order quantity
	d1 (mm)	d2 (mm)	h (mm)	D (mm)	Gwint zewnętrzny	Gwint wewnętrzny	
TP02-98.2	98.2	103.3	28.8	106	-	-	300
TP02-101.9	101.9	107.5	28.6	109	-	-	300
TP02-106.7	106.7	111.7	28.6	113.3	-	-	250
TP02-108	108	114.1	35.2	118.5	-	-	250
TP02-109	109	113	27	123	-	-	175
TP02-110	110	115	28	118.5	-	-	250
TP02-111.5	111.5	117.6	35	122	-	-	250
TP02-112.1	112.1	114.3	28.6	116.8	-	-	250
TP02-124	124	128	23	134	-	-	150
TP02-129	129	135.1	36.5	139.5	-	-	150
TP02-133	133	137	22	143	-	-	150
TP02-139.5	139.5	145.6	36.5	150	-	-	150

Article num..	Dimensions						Minimum order quantity
	d1 (mm)	d2 (mm)	h (mm)	D (mm)	Gwint zewnętrzny	Gwint wewnętrzny	
TP02-142,5	142,5	148	33	159.5	-	-	200
TP02-146.8	146.8	151	30,5	159.5	-	-	100
TP02-153	153	161.5	29,6	178.9	-	-	180
TP02-157	157	163	38	172	-	-	100
TP02-164	164	166	21.5	174	-	-	150
TP02-168	168	172	38	190	-	-	70
TP02-168B	168	172	21.6	179	-	-	150
TP02-173	173	181,3	38,5	195	-	-	120
TP02-177	177	185	38	195	-	-	80
TP02-187,5	187,5	191,5	21.7	197,5	-	-	130
TP02-192	192	200	38	215	-	-	120
TP02-199	199	204	38	214	-	-	100

Article num..	Dimensions						Minimum order quantity
	d1 (mm)	d2 (mm)	h (mm)	D (mm)	Gwint zewnętrzny	Gwint wewnętrzny	
TP02-203.5	203.5	208.5	26	216	-	-	12
TP02-216	216	223.6	29.1	241.5	-	-	100
TP02-207,5	207,5	212	26.5	223	-	-	100
TP02-221,5	221,5	230	23.7	237	-	-	125
TP02-223	223	230,5	38	240	-	-	100
TP02-232	232	239	46	250	-	-	80
TP02-238	238	250	46	263	-	-	100
TP02-249	249	254	46	264	-	-	70
TP02-250	250	261	46	280	-	-	80
TP02-270	270	281	43	297	-	-	50
TP02-278	278	286	46	304	-	-	35
TP02-284	284	293	46	315	-	-	100

Article num..	Dimensions						Minimum order quantity
	d1 (mm)	d2 (mm)	h (mm)	D (mm)	Gwint zewnętrzny	Gwint wewnętrzny	
TP02-292	292	299	46	315	-	-	80
TP02-298	298	301	23	314	-	-	120
TP02-313	313	325	50,5	340	-	-	50

This document does not constitute technical documentation of the product and is for reference only. Polyamide reserves the right to change the product characteristics without prior notice.

<https://poliamid.com/produkt/korki-stozkowe-2/>

08.12.2024 18:46:02